

# ASSEMBLY INSTRUCTIONS

HAND SANITIZER DISPENSER

WALL MOUNTED

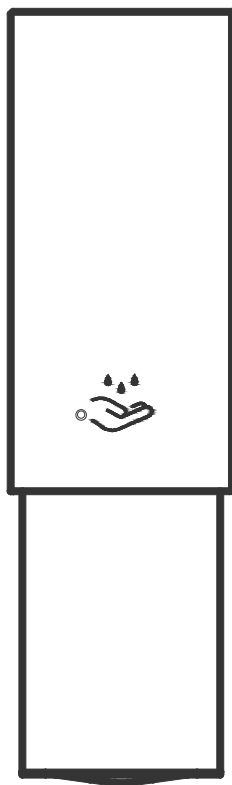

# TABLE OF CONTENTS

Instructions

- 1. Important Safety Information ..... 3
- 2. Parts Included ..... 4
- 3. Assembling ..... 5
- 4. Using the Device ..... 11
- 5. LED Indicator Light ..... 11
- 6. Attention and Troubleshooting ..... 12
- 7. Cleaning and Maintenance ..... 13
- 8. Warranty Information ..... 14

# IMPORTANT SAFETY INFORMATION

## READ THIS INFORMATION BEFORE USING YOUR PRODUCT

Before you use your product, it is important that you read and understand the information found in this guide. Basic precautions should always be followed, including the following:

- \* This appliance is not intended for use by persons (including children) with reduced physical, sensory or mental capabilities, or lack of experience and knowledge, unless they have been given supervision or instruction concerning use of the appliance by a person responsible for their safety.
- \* This product is not a toy. Intended for adult use only.
- \* This product is for indoor use only.
- \* Do not allow children to play with this product.
- \* Ensure product is always in an upright position.
- \* Cleaning and user maintenance shall not be made by children without supervision.

## PARTS INCLUDED

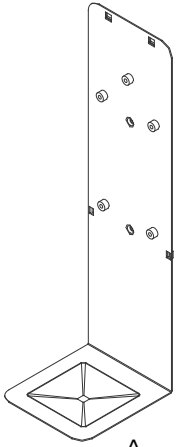

A



B



C



D

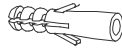

E



F

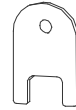

G

- Part A: Drip Tray (1)
- Part B: Hand sanitizer dispenser (1)
- Part C: Metal cover (1)
- Part D: Mounting Screws (3)
- Part E: Anchors (2)
- Part F: Anchor Screws (2)
- Part G: Key (1)

# ASSEMBLING

Carefully unpack your new product and lay out all the parts on a clear area. Take care not to lose any small parts.

## STEP 1

Hold the Drip Tray (A) against a wall to determine a desired mounting location. Use a pencil to mark the general location of the two hole cutouts located on the Drip Tray (A). Drill two holes into the wall for inserting the Anchors (E). Insert the Anchors (E) into the holes in the wall. Attach the Drip Tray (A) on the wall. Use the screwdriver to secure the Anchor Screws (F) into the The Anchors (E). Tighten the Anchor Screws (F) until the Drip Tray (A) is secured.

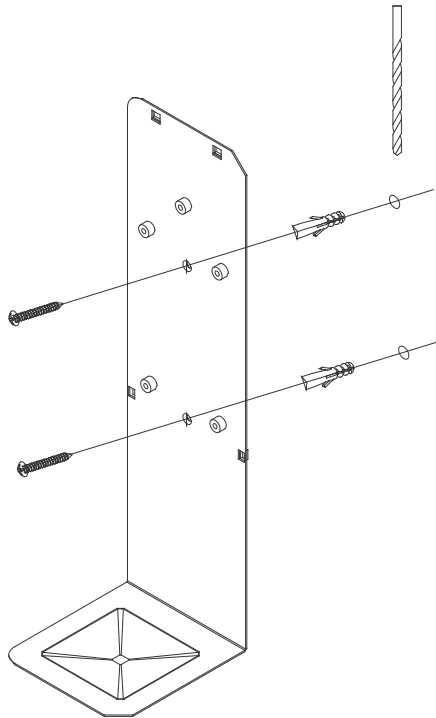

## STEP 2

To open the dispenser, use the provided Key (G) to press down at the top of the front housing where the key slots are located. Hold the dispenser from the top and gently pull the front housing down and toward you. The front housing is hinged at the bottom of the dispenser.

Grasp the holder with both hands and press it inward slightly, then pull out the Assembly, put the Assembly aside for later use.

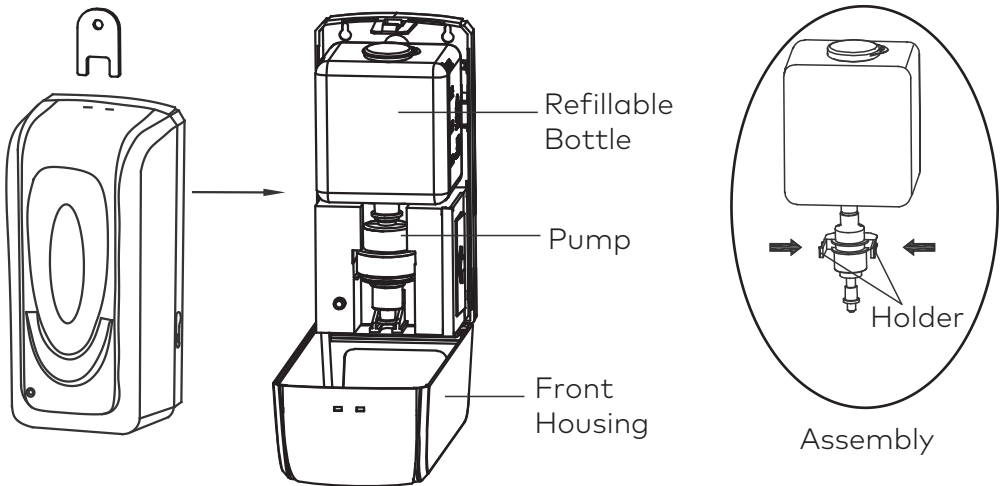

STEP 3

Unscrew the Mounting Screws (D) from the Drip Tray (A), align the holes on the dispenser back housing to the holes on the Drip Tray (A), secure with the provided Mounting Screws (D).

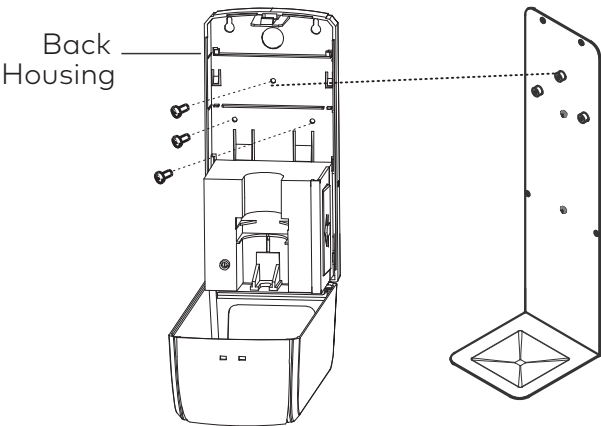

## STEP 4

Locate the battery box, slide the battery box cover forward, place four (4) C cell alkaline batteries in the proper orientation and replace the battery box cover.

Do not mix old and new batteries. The use of re-chargeable batteries is not recommended.

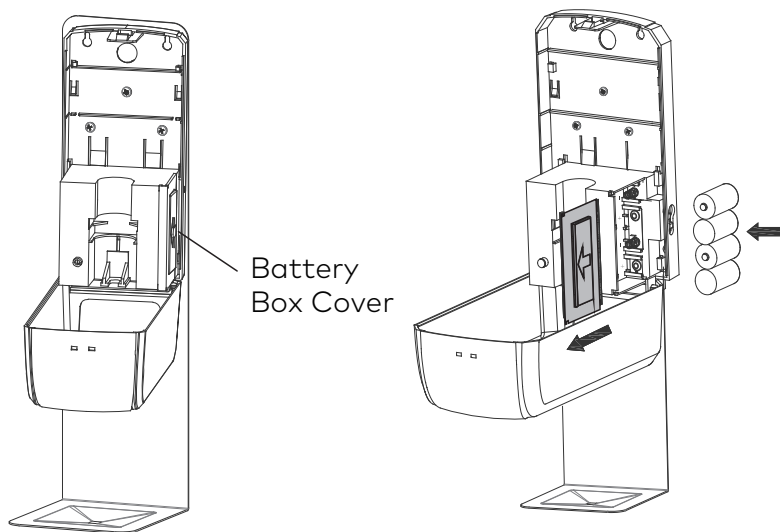



STEP 5

Place the Assembly into the control box, the pump should fit into the groove on the control box. Make sure the pump nozzle is at the correct location. Pour the sanitizer into the refillable bottle. Close the dispenser front housing.

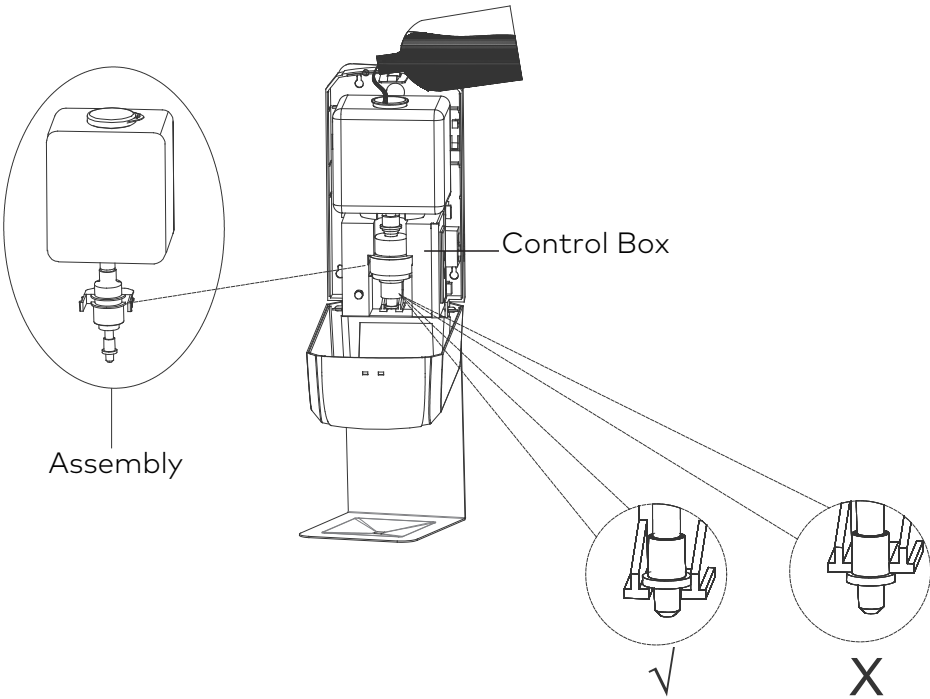

STEP 6

Place the Metal Cover (C) over the dispenser, make the Metal Cover (C) sits into the hook on the back of the Drip Tray (A).

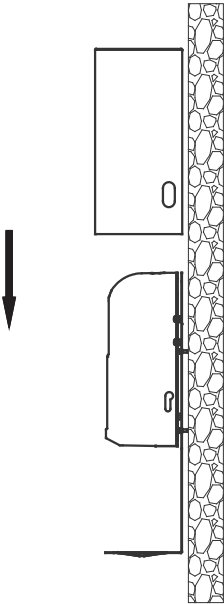

## USING THE DEVICE

1. Turn on the switch.
2. Place hand(s) underneath the dispenser within 6cm of the sensor. The LED will blink GREEN and dispense 0.8ml of sanitizer into your hand(s).
3. To receive additional sanitizer, remove hands from below dispenser and repeat 2.

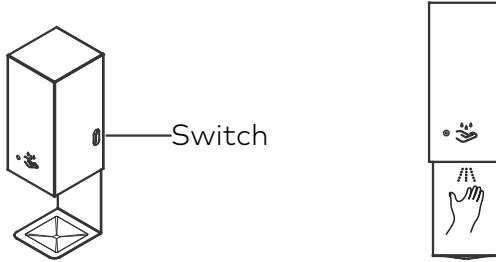

## LED INDICATOR LIGHT

1. Green color 5 seconds flash: working condition.
2. Red color 5 seconds flash: low battery charge.
3. Red color 2 seconds flash: something is under sensor and should be removed.
4. Red color keeps flashing: low volume sanitizer.

## ATTENTION

- \* Please allow for a 1 minute warm up period after turning on the unit.
- \* Please note that the user's hands are to be inserted from front to back to trigger the sensor that is situated to the left of the center.
- \* Please do not take apart the refillable bottle from the pump, keep the refillable bottle and the pump assembly, unless replace the individual refillable bottle and the individual pump.

## TROUBLESHOOTING

### No Dispense, Motor Does Not Run

- \* Hands are not directly underneath sensor
- \* No refill is loaded
- \* Incorrect refill is loaded
- \* Batteries are not loaded, or are loaded incorrectly

### No Dispense, Motor Runs

- \* Refillable bottle is empty or is loaded improperly
- \* Pump is not primed

## CLEANING AND MAINTENANCE

\* To clean the outside of the product, use a dry or slightly dampened clean cloth (use clean water, never a solvent) to wipe the surface of the product.

\* Do not use any cleaners with chemicals, solvents or harsh abrasives. Use only a dry soft cloth to dust or wipe carefully.

## WARRANTY INFORMATION

This product is one year warranty of manufacturer's defects from date of purchase.