

E40-F

ELECTRIC TOWEL HEATER INSTALLATION MANUAL

WARNING

In order to avoid a hazard for very young children, this appliance should be installed so that the lowest heated rail is at least 600 mm above the floor. This appliance is not intended for use by persons (including children) with reduced physical, sensory or mental capabilities, or lack of experience and knowledge, unless they have been given supervision or instruction concerning use of the appliance by a person responsible for their safety. Children should be supervised to ensure that they do not play with the appliance.

If the supply cord is damaged, it must be replaced by the manufacturer, its service agent or similarly qualified persons in order to avoid a hazard. This appliance can be used by children aged from 8 years and above and persons with reduced physical, sensory or mental capabilities or lack of experience and knowledge if they have been given supervision or instruction concerning use of the appliance in a safe way and understand the hazards involved. Cleaning and user maintenance shall not be made by children without supervision.

Short cord instruction

- a. To reduce the risk of injury, do not drape cord over the counter top or table top where it can be pulled down by children or tripped over unintentionally.
- b. A short power-supply cord (or detachable power-supply cord) is provided to reduce risks resulting from becoming entangled in or tripping over a longer cord.
- c. Longer detachable power-supply cords or extension cords are available and may be used if care is exercised in their use.
- d. If a long detachable power-supply cord or extension cord is used
 - 1. The marked electrical rating of the detachable power-supply cord or extension cord should be at least as great as the electrical rating of the appliance;
 - 2. If the appliance is of the grounded type, the extension cord should be a grounding type 3-wire cord; and
 - 3. The longer cord should be arranged so that it will not drape over the counter top or table top where it can be pulled on by children or tripped over.

E40-F

ELECTRIC TOWEL HEATER INSTALLATION MANUAL

PRODUCT INFORMATION

Size	505x665x210mm
Voltage	120V
Power	115W
Frequency	60Hz
Color	Matte Black
Cord length	1.5 m
Material	304 stainless steel

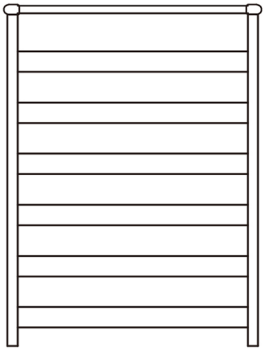

DIMENSIONS Unit:mm

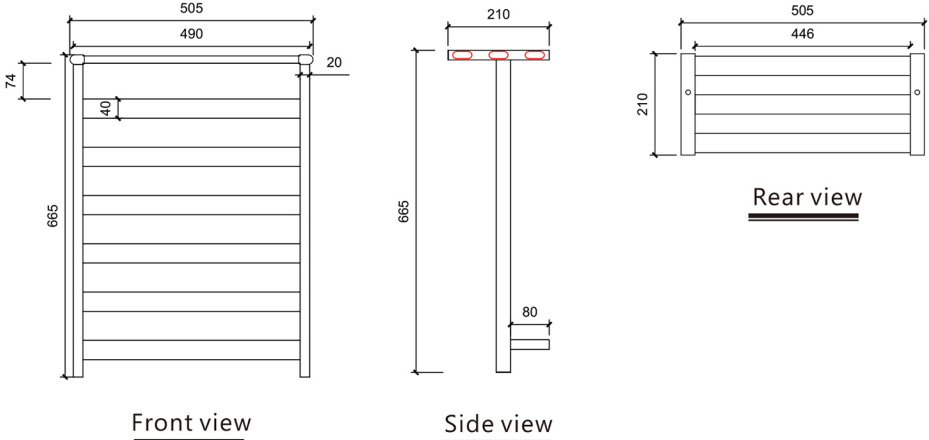

E40-F

ELECTRIC TOWEL HEATER INSTALLATION MANUAL

Please read through these instructions before installation

1. Never use cleaners containing abrasive cleansers, ammonia, bleach, acids, waxes, or solvents for cleaning as they may damage the finish. Do not allow any liquid into the products. Do not wash the product directly with water. Do not allow any liquid into the product.
2. The single bar of the product can bear 10kgs, and do not hang overweight items.
3. Please do not disassemble or modify the product by yourself. Do not attempt to repair this product as it may cause accidental injury.
4. If the product is abnormal and cannot be used normally, please immediately cut off the power supply and contact the after-sales staff for inspection and maintenance.
5. Make sure the power to the unit is off, and the power cord is unplugged from the wall outlet before proceeding with installation.
6. The product must be installed by a qualified electrician.

PRODUCT ACCESSORIES LIST

1

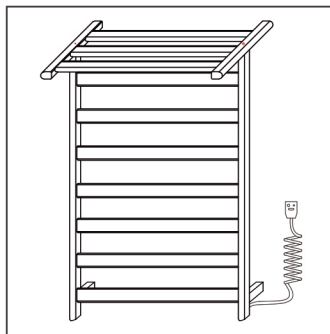

2

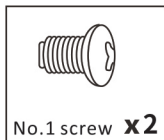

No.1 screw x2

4

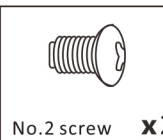

No.2 screw x2

3

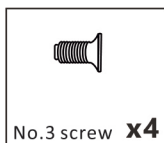

No.3 screw x4

5

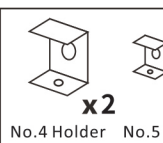

No.4 Holder x2 No.5 Holder x2

6

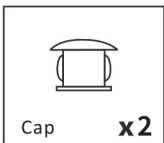

Cap x2

7

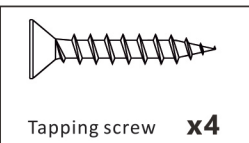

Tapping screw x4

8

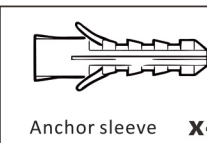

Anchor sleeve x4

INSTALLATION STEPS

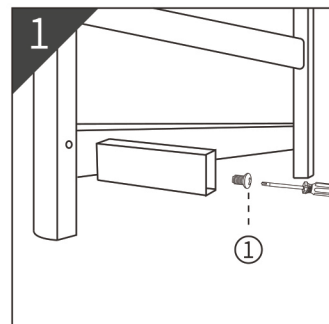

Fix the feet of the main frame (use the No. 1 screws to install the feet in the corresponding position of the body)

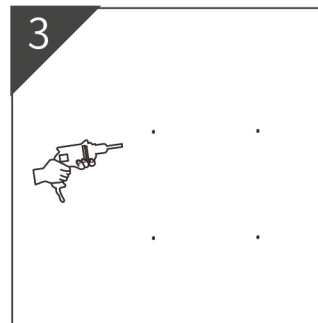

Position and drill holes on the wall according to actual measurement.

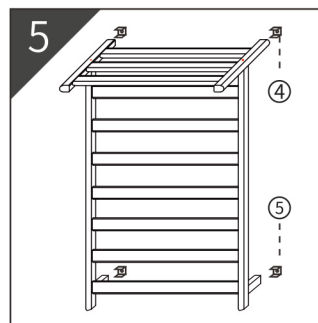

Set the main frame onto the base on the wall.

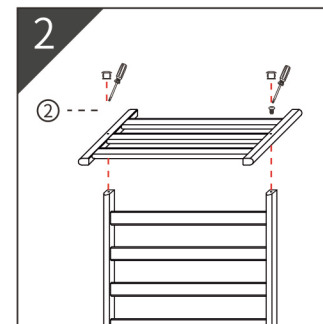

Install the shelf to the main frame with No. 2 screws, and cover with the caps.

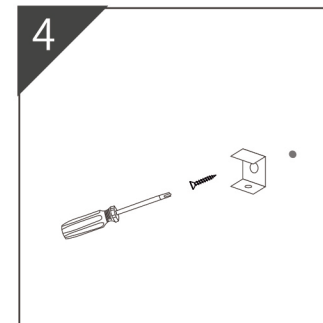

Put the anchor sleeves into the holes on the wall, and then fix the base on the wall with screws.

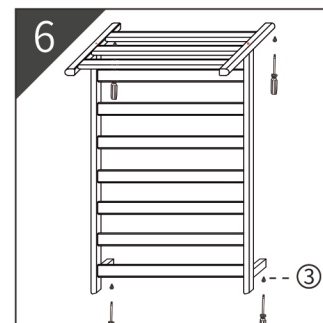

Use No.3 screws to fix the frame to the base.