

Shower System

Contents

Before Use

General Guidelines..... 03

Before Installing..... 03

Installation Guide

Assembly Instructions..... 03

Precautions and Maintenance..... 03

Parts List..... 04

Rough-in & Water Pipe Installation Guide..... 05

Installation Steps..... 06

Operation

Trouble Shooting..... 08

General Guidelines

1. Check the package and confirm all parts are included. If any part is missing or damaged, please contact us.
2. Do not disassemble the main body, as it has been installed & commissioned correctly & precisely before leaving the factory.
3. Shut off the main water supply prior to beginning installation.
4. Do flush the water supply lines to remove any dirt and debris before installation (**IMPORTANT**).
5. Make sure to connect the hot/cold inlet pipe correctly. If standing in front, connect hot water pipe to the left and cold water pipe to the right.
6. After the installation, check for leaks and make sure every joint is safely sealed.

Before Installing

Read entire shower system installation instructions.

For the following installation instructions for your new shower panel could be assumed that the water supply lines are in place behind the finished wall and are directly accessible for shower installation, please check the installation accordingly.

Assembly Instructions

TOOLS YOU MAY NEED

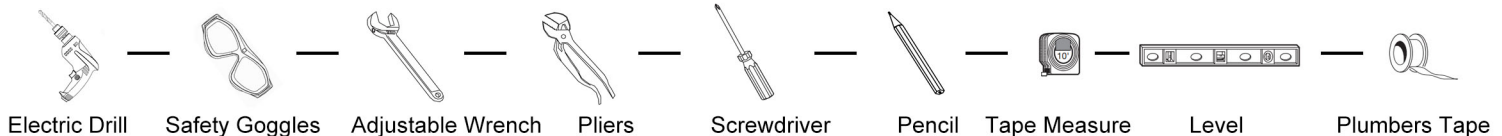

Precautions and Maintenance

1. In order to ensure the durability of the product please be as gentle and slow as possible during operation.
2. Clean the filter regularly.
3. When the shower is used for a long time and water is found to flow out intermittently there must be debris blocking the water outlet. At this time, you only need to gently touch & clean the soft rubber tips liquid or transparent glass detergent then rinse it with soft water, then gently wipe it with a dry soft cloth.
5. Do not use any scrubbing detergent, polisher, sand-cloth, paper tissue or scraper.
6. Do not use acid detergent, insoluble & grain-like detergent or soap.
7. If you will not use the shower for a long time please close the main water inlet valve in your home.
8. When the ambient temperature is under 0C/32°F, please take necessary measures to keep the water equipment warm.

Parts List

Please carefully check and verify the quantity of accessories before installation, and check if they are in good condition



1

Water inlet joint

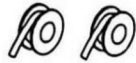

2

Teflon tape

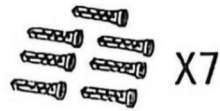

3

M4 expansion screw



4

Fixed hook

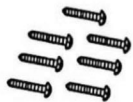

5

Self tapping screws



6

Internal buckle



7

Cross self tapping screw

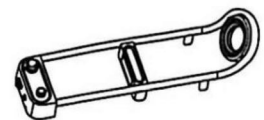

8

main body

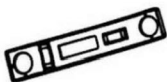

9

levelling instrument

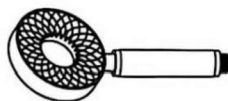

10

hand shower



11

hose



12

Rubber Gasket



13

Shower bracket



14

Rubber filter screen

Rough-in & Water Pipe Installation Guide

Please refer to the product installation dimension diagram for installation fees and determine the installation position. The actual installation process dimensions of this product shall prevail, and the specific installation shall be subject to the actual product.

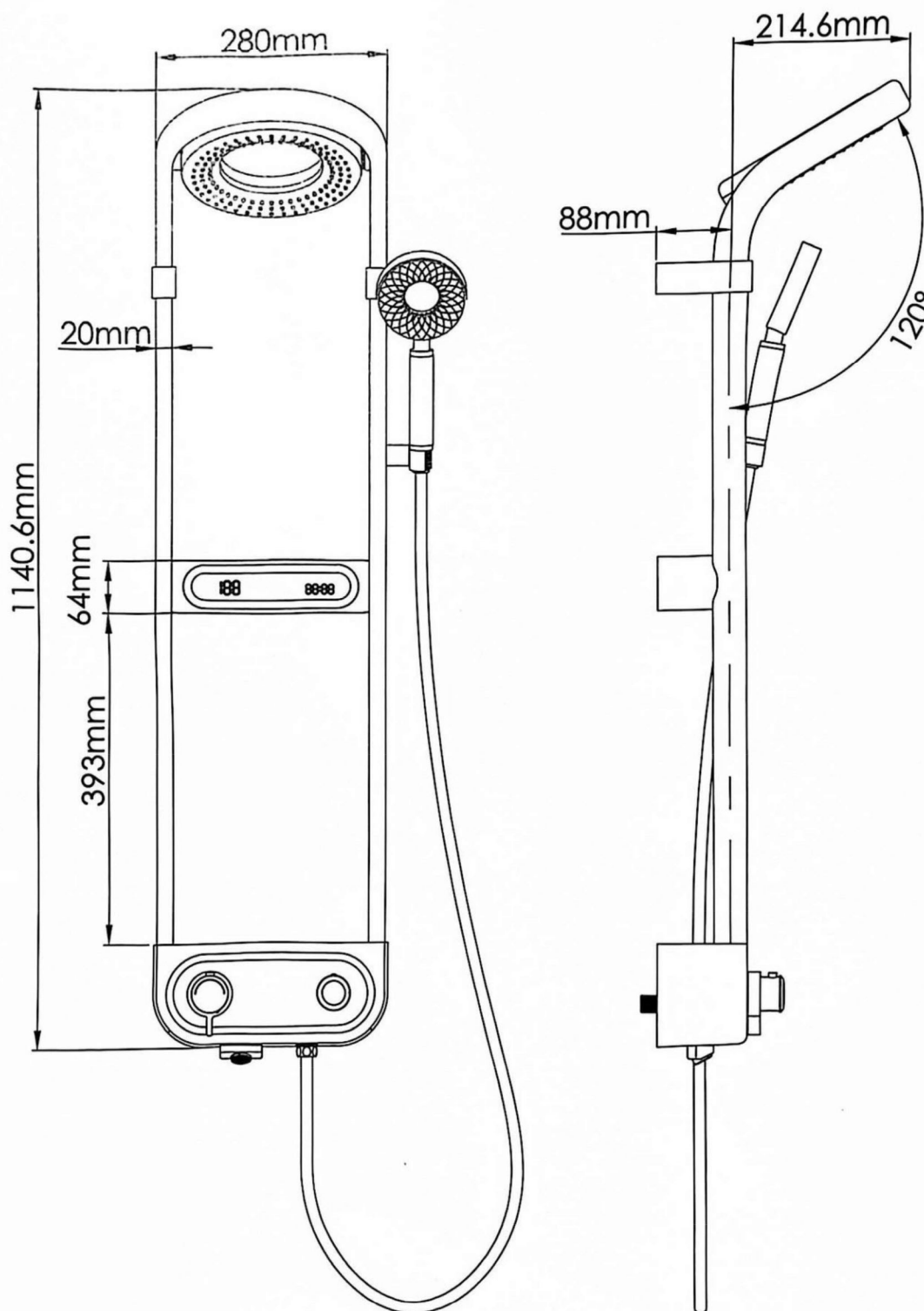

Installation Steps

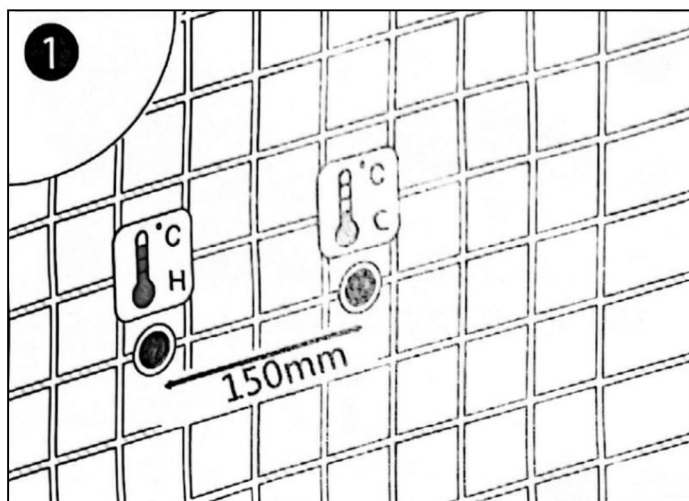

Center distance 150MM

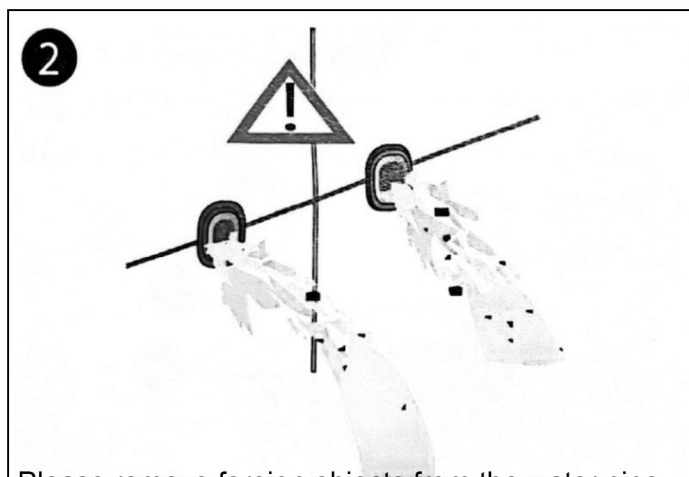

Please remove foreign objects from the water pipe before installation; The installation of water supply pipelines must strictly follow the principle of left hot and right cold

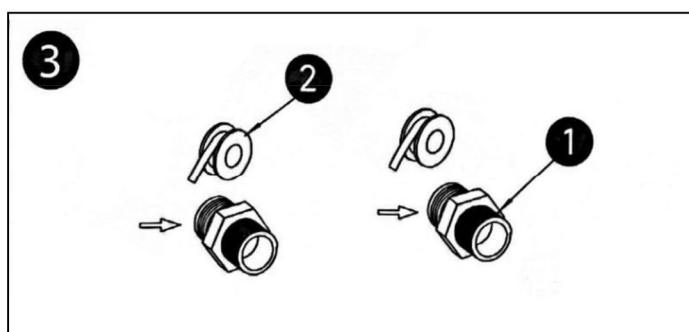

Wrap the raw material tape around the inlet joint and install it into the water pipe

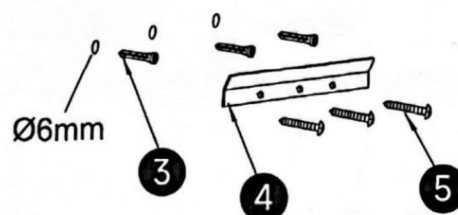
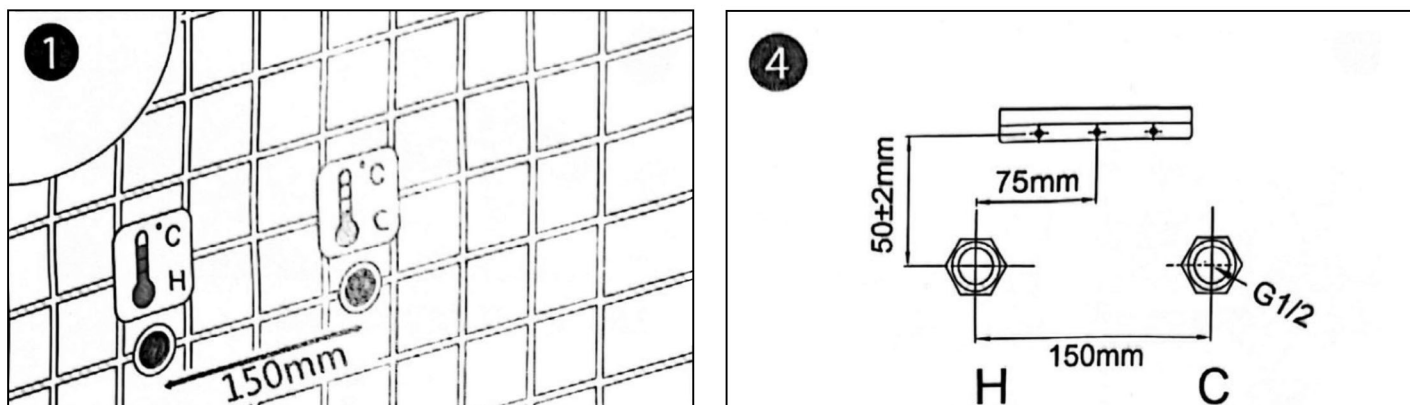

Drill three 6mm diameter holes on the wall, drive expansion nails into the wall, and tighten the cross screws through the fixed bracket.

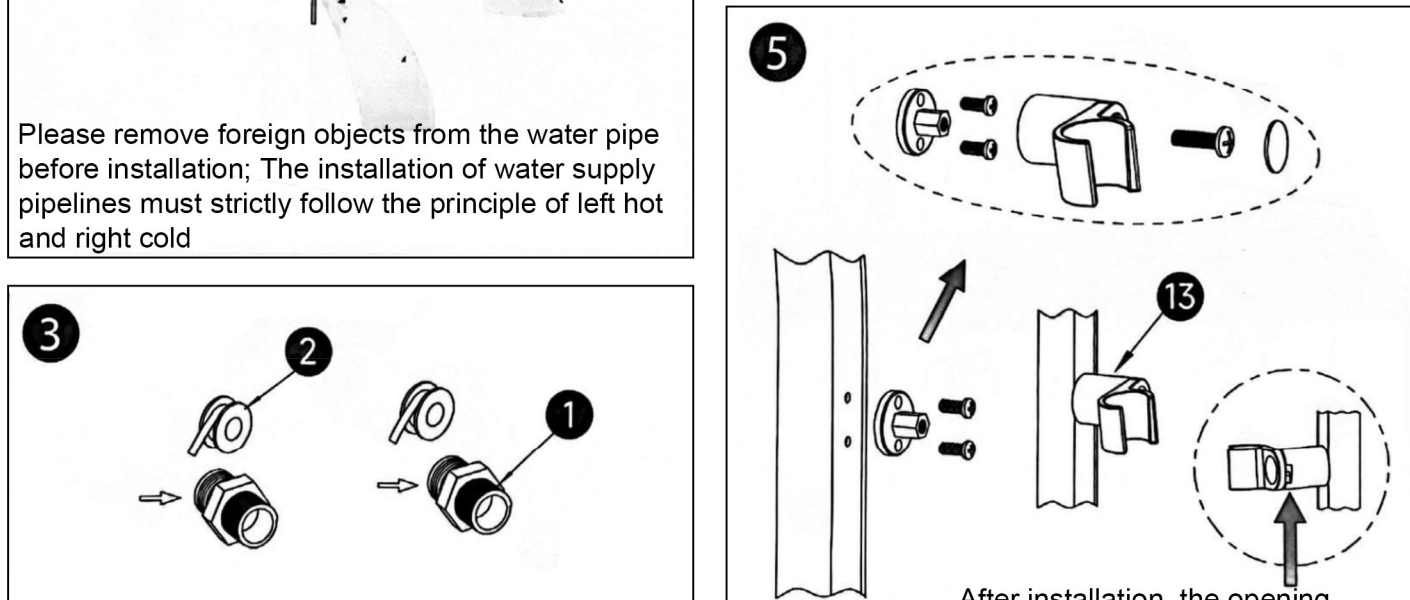

After installation, the opening should face back and pay attention to the direction of the opening

Remove the screws from the showerhead bracket, place the removed accessories on the corresponding two holes on the right side of the main faucet, and fix and lock them with self tapping screws. Insert the shower bracket kit onto the fixed accessory, secure it with screws, and then cover it with a small lid.

Installation Steps

6

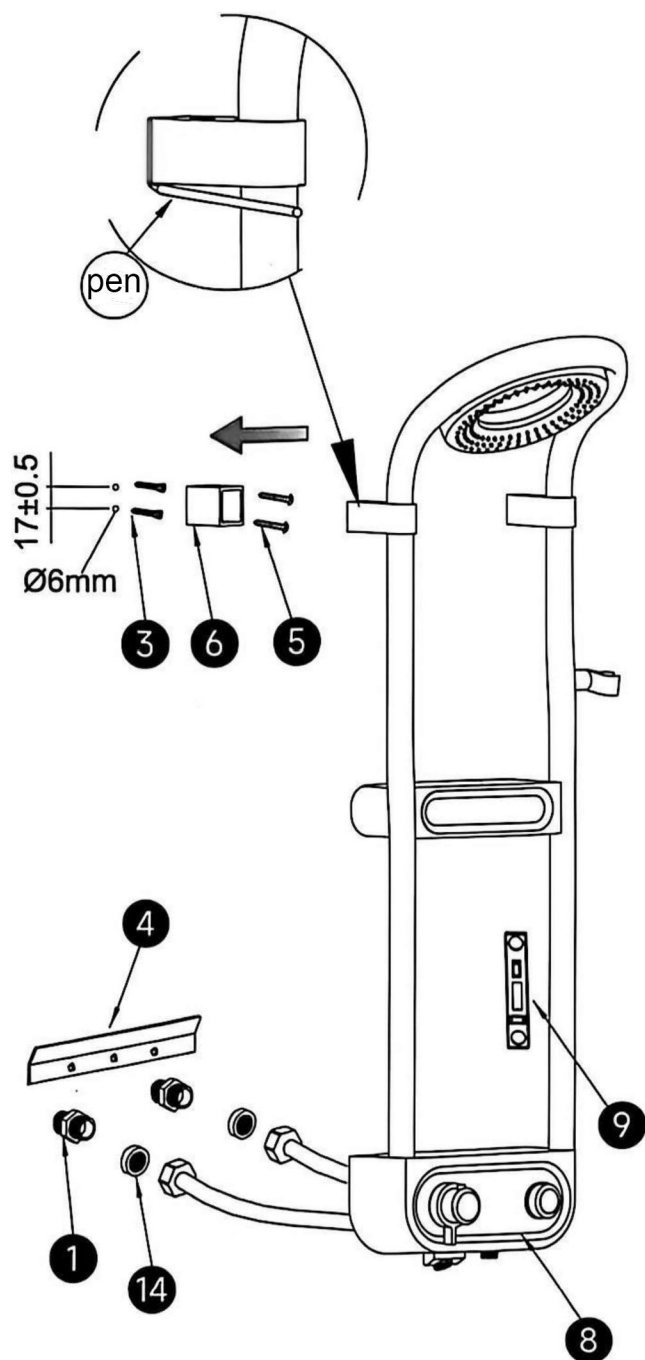

Insert the two water inlet pipes behind the main faucet into the wire mesh gasket and tighten the water inlet joint. Insert them into the faucet hook and adjust the level horizontally. Mark the wall with a pen on the upper bracket, then drill a hole in the wall and insert an expansion screw. Use a cross screw to pass through the inner card and insert it into the expansion screw. Insert the main faucet.

7

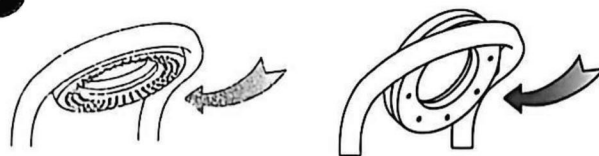

When switching the head function, push towards the wall and rotate 360 ° to achieve the function of water type switching

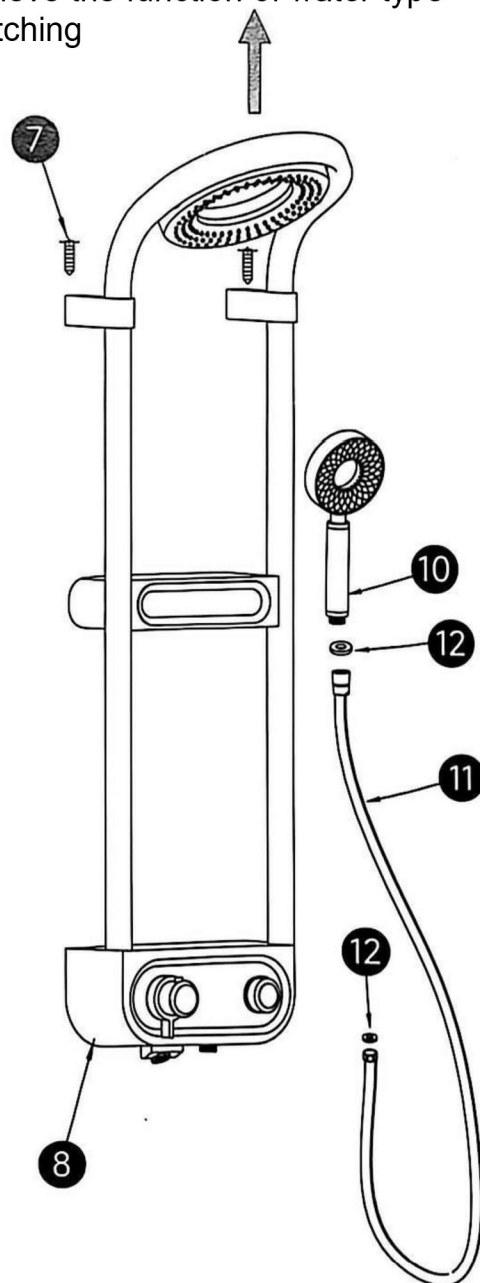

Insert the cross tapping nail into the hole above the main faucet bracket and tighten it. Place a rubber gasket at each end of the hose, tighten one end of the hexagonal cap to the bottom outlet interface of the main faucet, and tighten the other end to the handheld showerhead interface.

Troubleshooting

Problem	Possible Cause	Corrective Action
Water does not shut off completely.	1. O-ring is not seated correctly or worn. 2. Cartridge may be defective.	1. Reseat or replace O-ring. 2. Replace cartridge.
Leaks at waterline connection.	1. Worn or broken washer. 2. Faucet body may be defective.	1. Replace washer. 2. Replace faucet (contact us for the replacement).
Leaks from handle.	1. Cartridge may come loose. 2. Cartridge may be defective.	1. Reseat cartridge tight. 2. Replace cartridge.
Leaks at hose connection.	1. Hose connection is loose.	1. Tighten hose. 2. Replace hose.
Leaks at shower valve connection.	1. Connection may come loose or not sealed completely. 2. Defective shower valve inlet or outlet connector.	1. Check connections. 2. Replace valve body.
Diverter knob does not work.	1. Diverter cartridge may be defective.	1. Replace cartridge.
LED light does not Light or noisy LED showerhead.	1. Defective LED generator.	1. Replace LED spray head (for kitchen faucet). 2. Replace LED threaded pipe (for seperate faucet spout). 3. Replace LED generator (for others).
Low flow.	1. Check for water pressure problems. 2. Aerator may be dirty or clogged.	1. Clean or replace the aerator. 2. Remove waterflow restrictor if available. 3. Install booster or pump (if applicable).