

Installation Guide

Picture 1



Parts List: H*72, G*72, J*24pcs(4*10mm), K*12pcs (4*16mm), O*6 (17.3cm) , P*6 (7.5cm) S*2pcs(5*30mm), V*4pcs(4*25mm)

Picture 2



Step 1: Pass the wire A through the light pole B and tighten it as shown in the picture

Picture 3

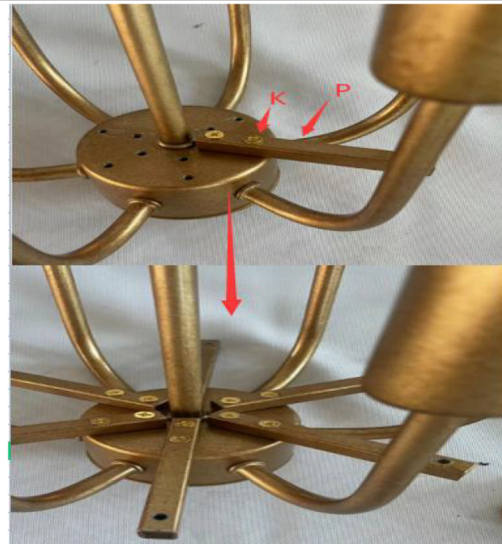

Step 2: Use K to fix P on the cluster body

Picture 4

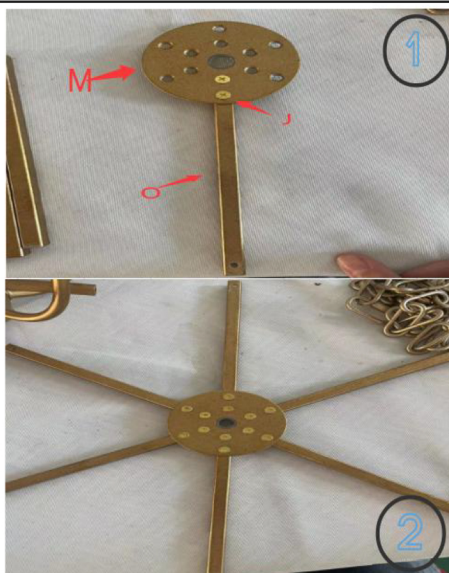

Step 3: Fix M and O with J

Picture 5

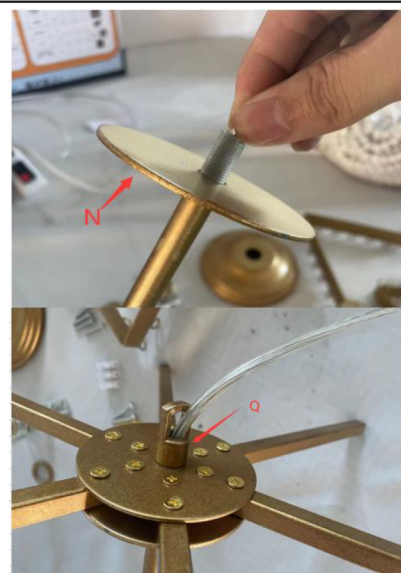

Step 4: Put in the corresponding accessories in sequence as shown in the picture, and tighten it with Q

Picture 6

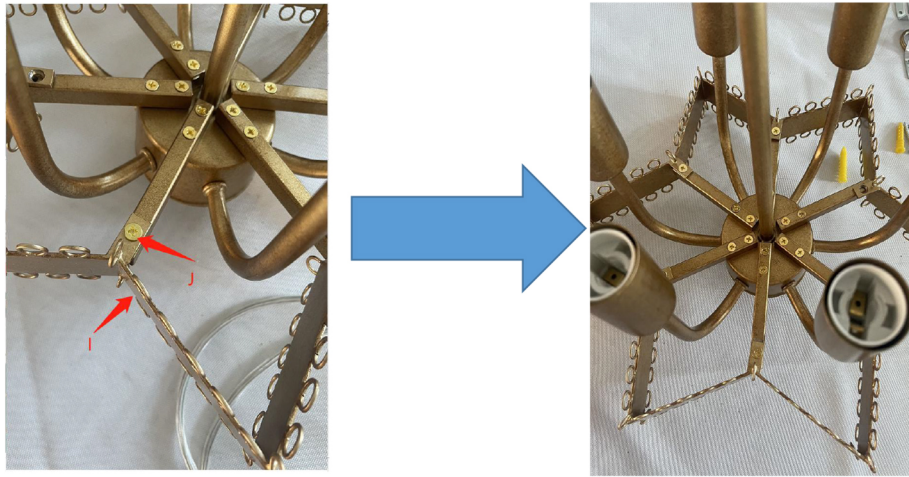

Step 5: Fix I with the screw J

Picture 7

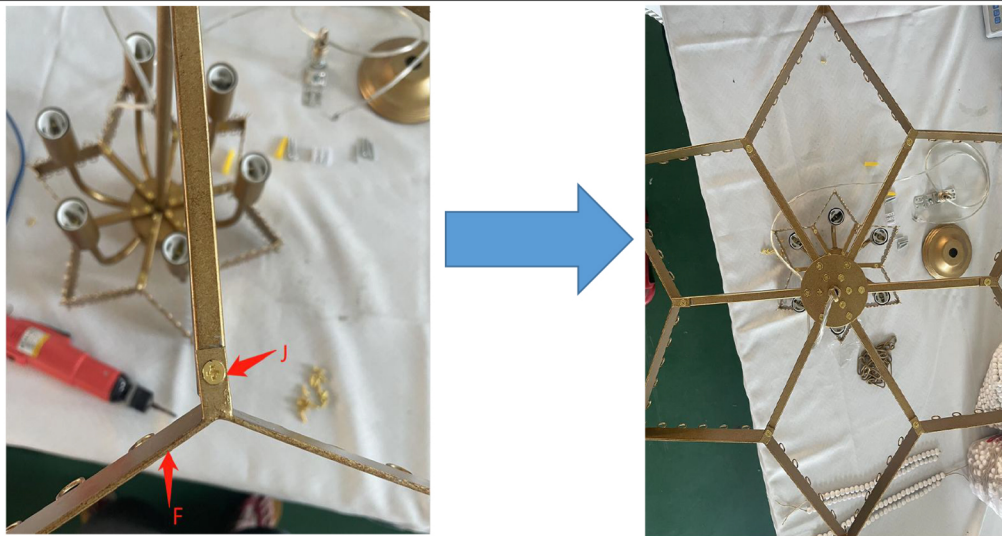

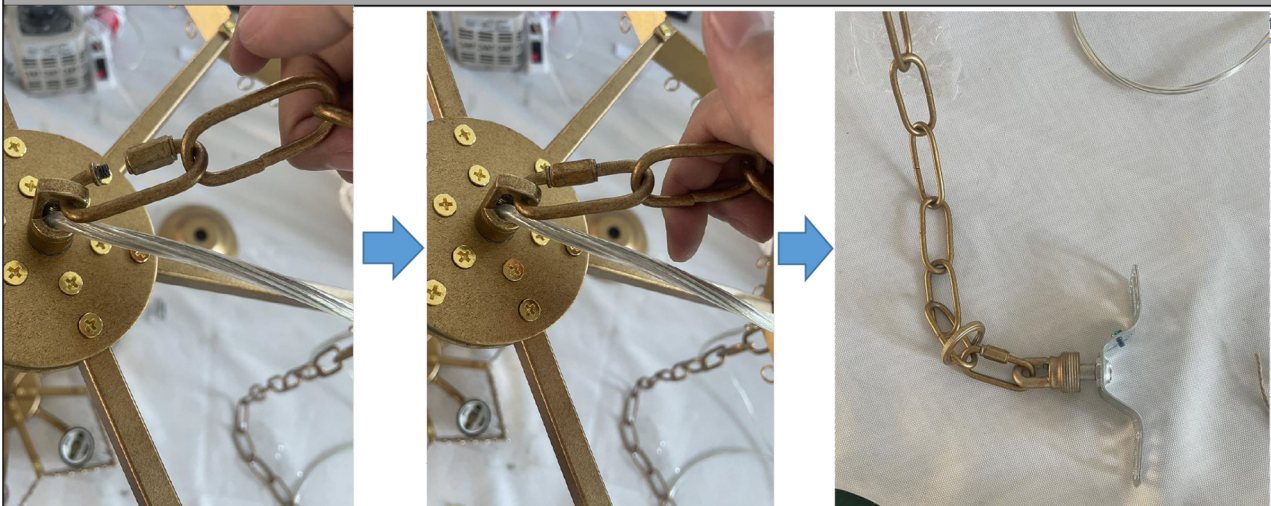

Step 6: Fix F with the screw J

Picture 8

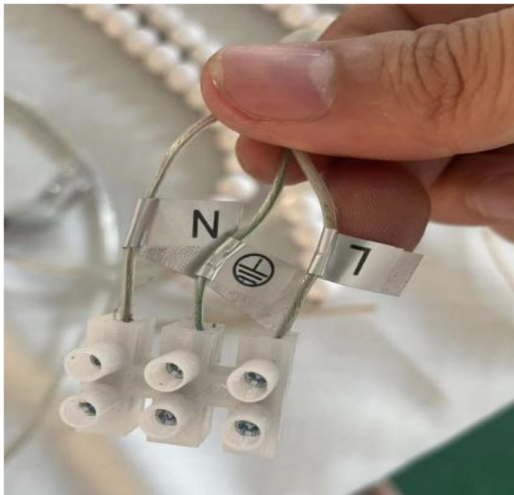
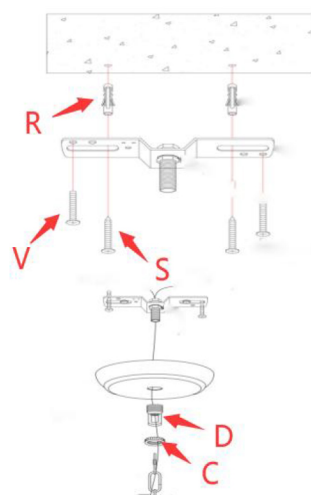
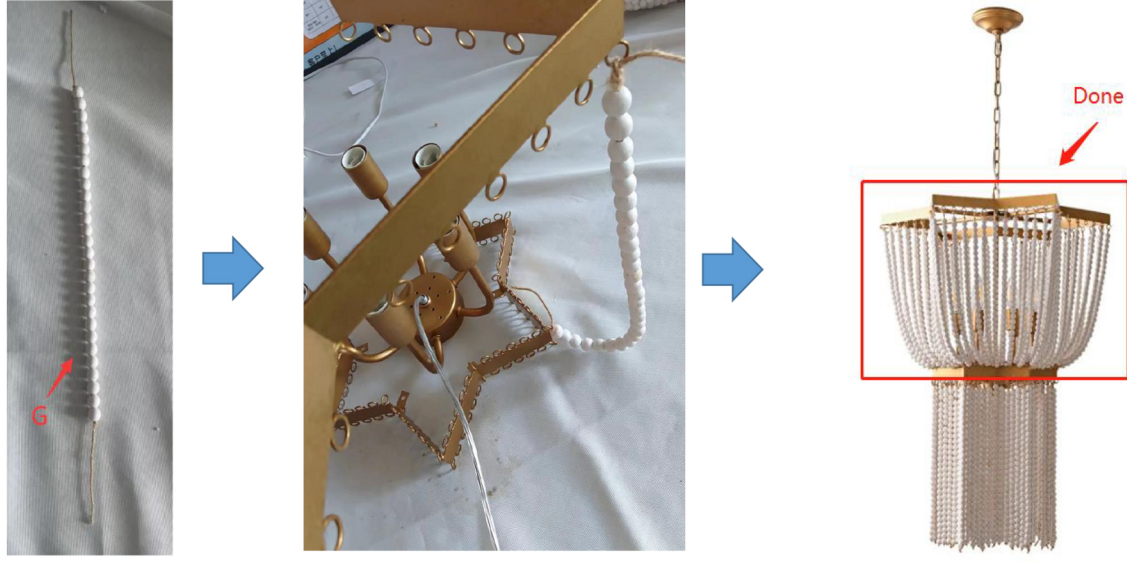
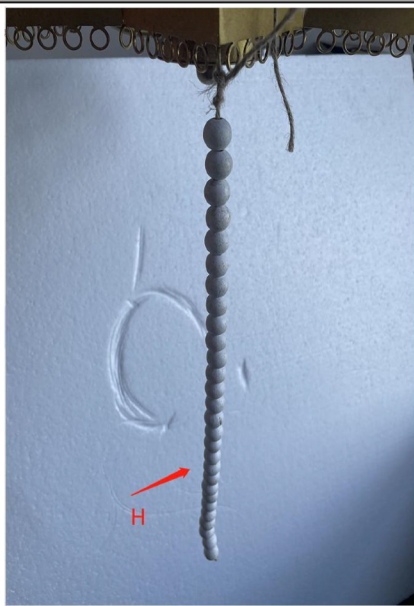

Step 7, Fix the hanging chain L

Picture 9	Picture 10
	
<p>Step 8: Wiring, connect the home power supply to the terminal, pay attention to the distinction between the zero and live wires</p>	<p>Step 9: Install the hanging board and fix the ceiling plate as shown in the picture</p>
Picture 11	
	
<p>Step 10: Tie G as shown in the picture</p>	
Picture 12	Picture 13
	
<p>Step 11: Tie H as shown in the picture</p>	<p>Finish the installation</p>