

Bathtub Faucet Installation

Tools You Will Need:

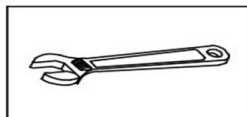

Adjustable wrench

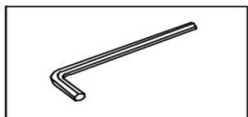

Hexagon wrench

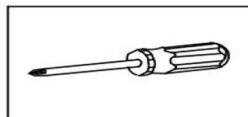

Philips Screwdriver

Before the Installation

1. Do not throw away packing materials until assembly is complete for small parts may come loose inside the carton during shipment. If parts are missing, please contact us.
2. Assemble this item on a soft surface, such as carpet to protect the finish.
3. Proper assembly of this item requires 2 people.
4. Periodically check to ensure that all connections are tight.
5. It is recommended that installation of the product be done by a qualified licensed plumber.

Care and Cleaning

1. To protect the finish, avoid use chemicals and household cleaners.
2. All hot serving dishes should be placed on a pad.
3. Any liquid spilled onto the top should be cleaned up immediately with a damp cloth.

Parts List

P.2/6

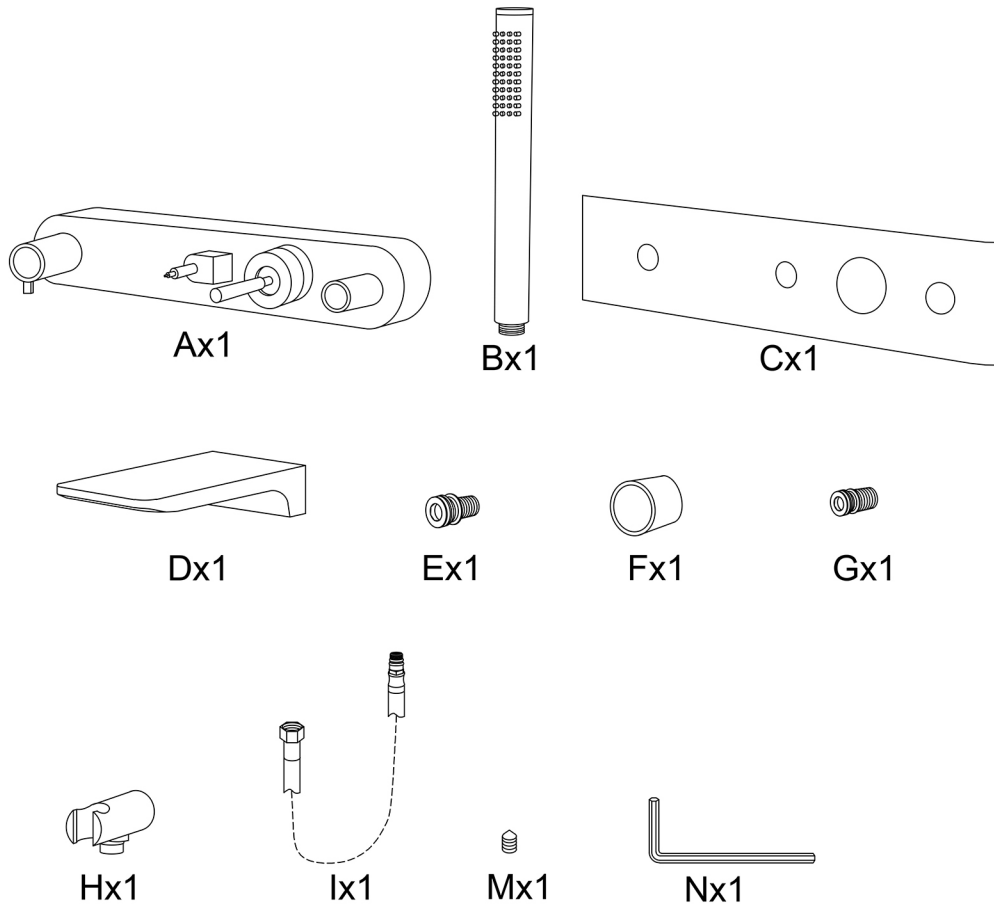
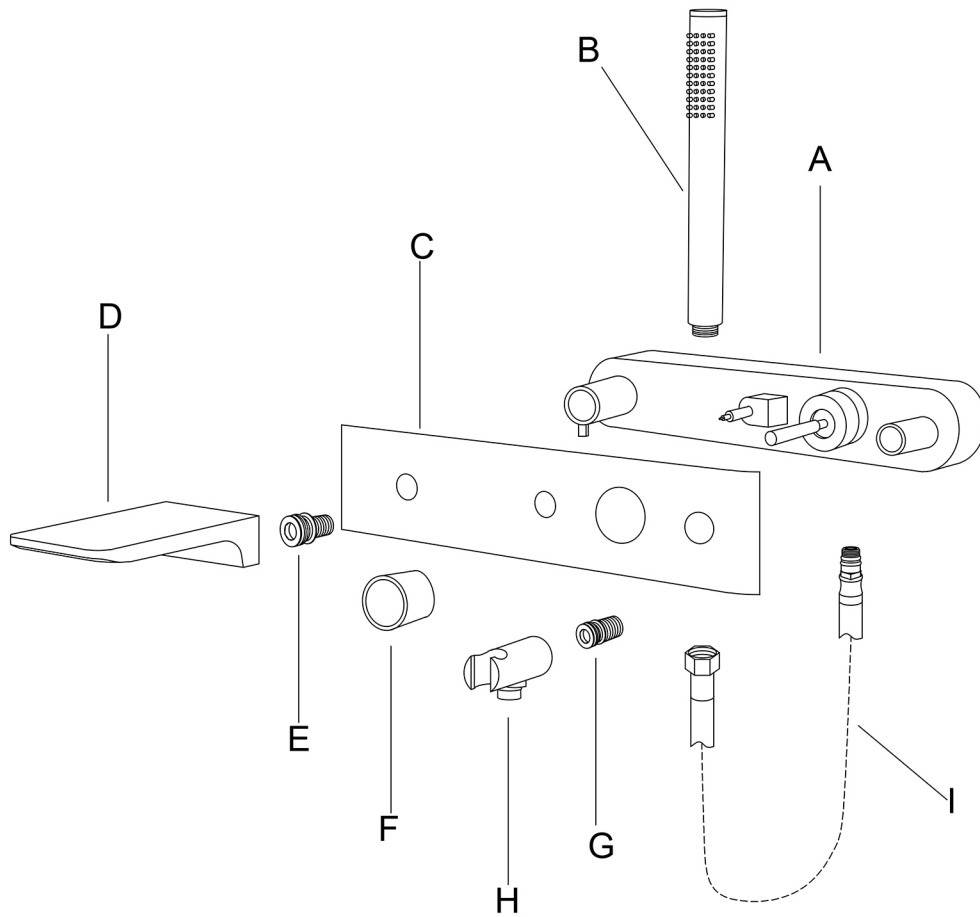

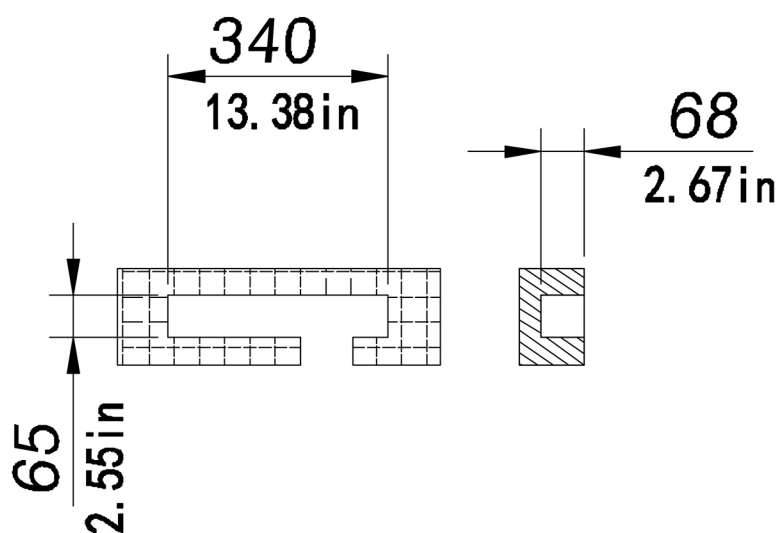

1.The valve body excavates hole size.L340 * H90 * D68 mm(L13.38 * H2.55 * D2.67 IN)

Step 2

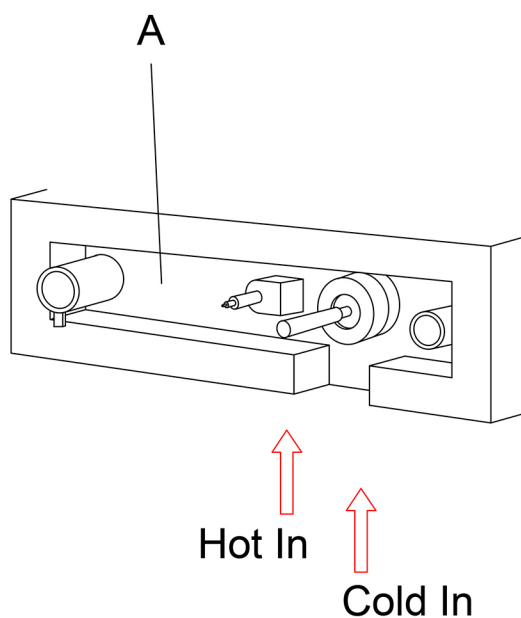

2.Turn off the main switch, adjust the cold and hot water inlet interface and the upper and lower water outlet interface, and use screws to fix the valve body in the wall.

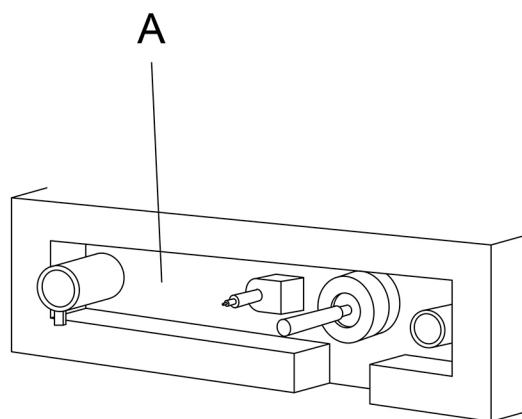

3.The installation in the wall is completed and the switch is opened for sealing test.

Step 4

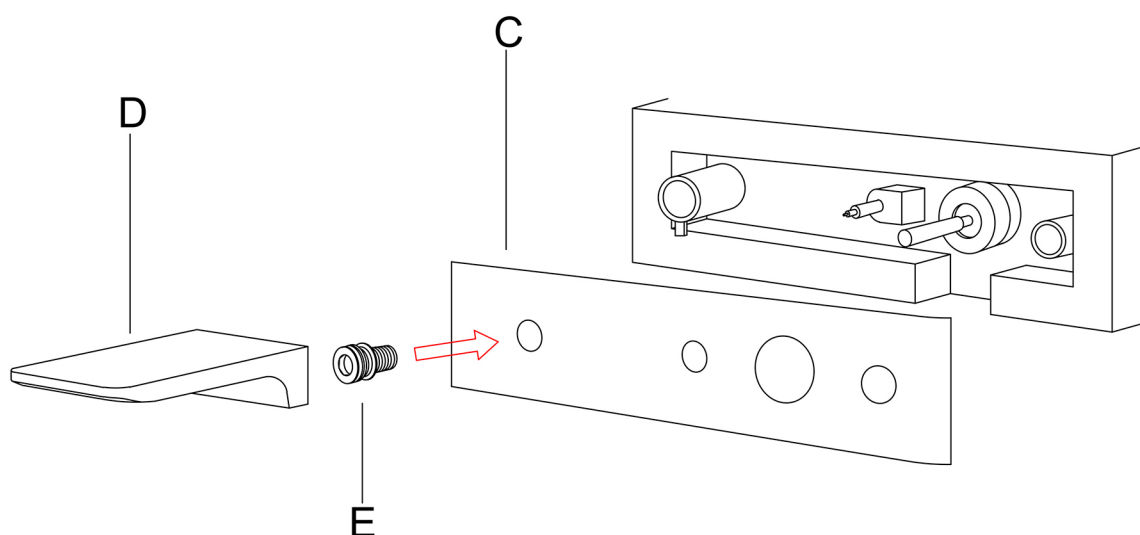

4.Installation panel: the valve body is fixed, and the panel is covered on the valve body.

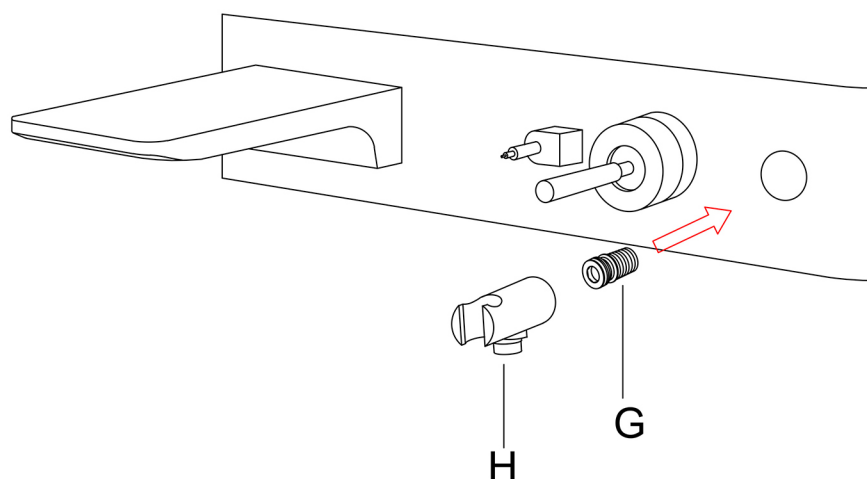

5. Install the lower water outlet part:
use the connecting pipe connecting
the valve body of the outlet to the
lower interface.

Step 6

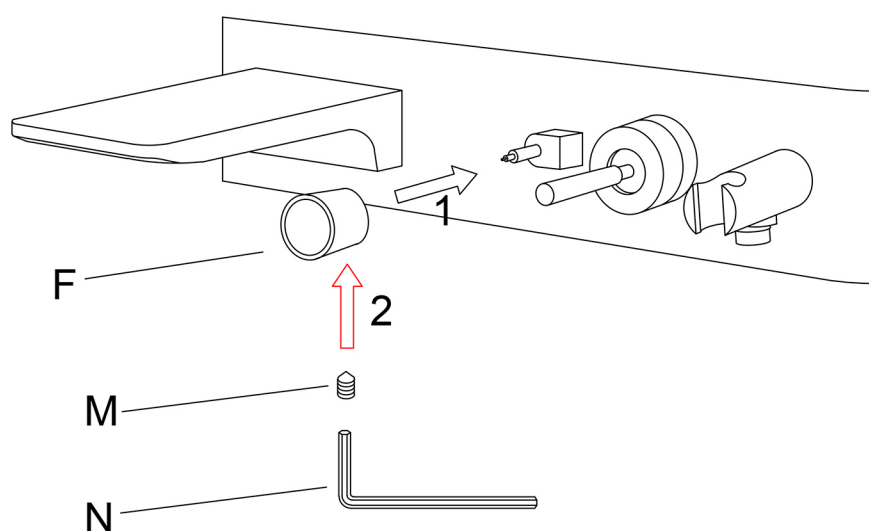

6. Install handle: put two handles on
top and lock with hexagonal wrench.

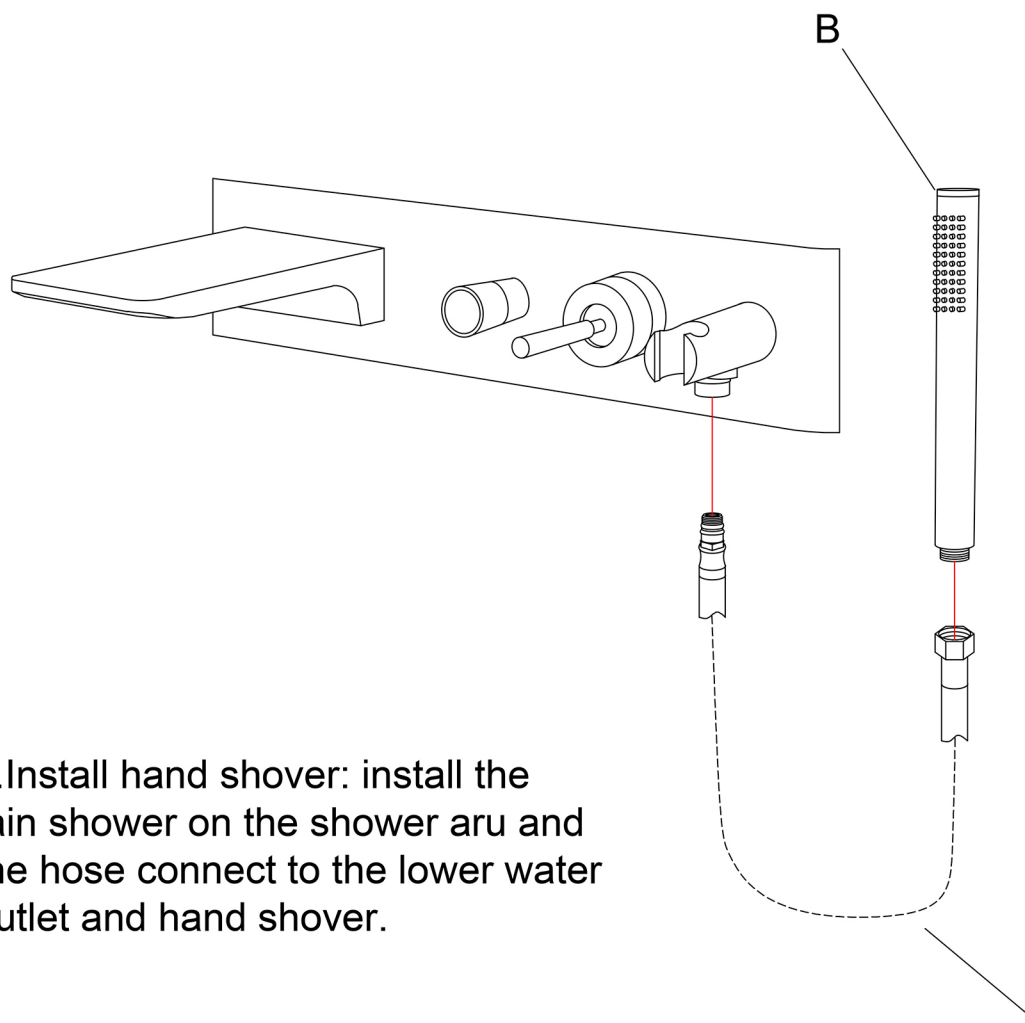

7. Install hand shower: install the rain shower on the shower arm and the hose connect to the lower water outlet and hand shower.